



SIP Industries

Quality Manufacturers Since 1960

EZ GRIP®
EZPVCUPTP

4" - 12" ULTRA PIPE TO PIPE BELL JOINT RESTRAINT FOR PVC PIPE

Submittal Information

Project Name / Location:	
Engineer:	
Referenced Specs:	
Distributor / Contractor:	

Optional Specifications

Coating:	EnviroShield, Direct To Metal (DTM) Alkyd Enamel (Red)		
	EZ-Shield® Polyester Based Powder Coating (Red)		
	Other - Specify:		
Rods & Nuts:	Standard High Strength Low Alloy Steel (HSLA) In Accordance With ANSI/AWWA C111/A21.11		
	Fluoropolymer Corrosion Resistant Coating		
	Stainless Steel:	Type 304	Type 316
	Other - Specify:		

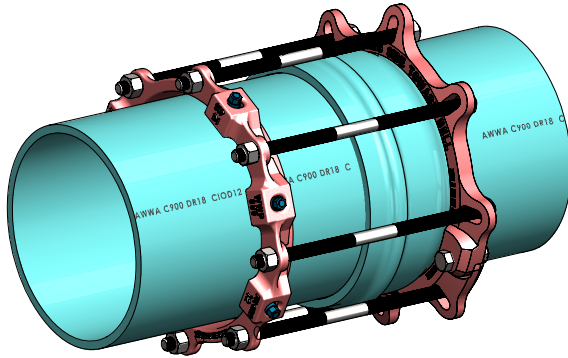

General Specifications

- Material** : Split harness, restraint gland, wedges, twist-off nuts and actuating screws are Ductile Iron per ASTM A536, Grade 65-45-12.
- Pressure** : Pressure rating equal to that of the PVC pipe rating, with a minimum 2:1 safety factor.
- Dimensions** : Split harness and restraint gland are compatible with 4"-12" AWWA C900 (PVC) and C909 (PVC0) pipe.
* Please check the below Max Bell O.D. dimensions that the harness rods will clear with.
- Installations** : Install in accordance with SIP installation procedures and intent of AWWA C605 / M23.
Pipe ends must be free from defects to allow proper engagement of wedges with the pipe.
For new Pipe to Pipe installation only. ***Not for use with IPS PVC Pipe to Pipe applications**
Note: There are no additional tools required for installation other than the tools required to install standard sizes of hex nuts from 5/8" - 1 1/4". The hex heads, bolts and rods shall be designed to tighten clockwise.
- Deflection** : Restraint allows the full joint deflection dictated by pipe manufacturer's recommendation, and maintains the seal while under pressure, and while subjected to ground movements.

Technical Specifications

Select Size	Size	O.D.	C900/C909 PVC Pipe Restraint		Harness Restraint Glands		Max. Bell O.D.	Restraint Rods		Clamping Bolts		Approx. Weight (Lbs)
			Item Code	Qty	Item Code	Qty		Qty	Size	Qty	Size	
	4	4.80	EZPVCU04	1	EZDPTPSG04	2	6.75	4	3/4 X 17	2	3/8 X 3 1/2	20
	6	6.90	EZPVCU06	1	EZDPTPSG06	2	9.23	6	3/4 X 17	2	3/8 X 3 1/2	30
	8	9.05	EZPVCU08	1	EZDPTPSG08	2	11.50	6	3/4 X 17	2	3/4 X 4	40
	10	11.10	EZPVCU10	1	EZDPTPSG12	2	14.15	8	3/4 X 24	2	7/8 X 5	55
	12	13.20	EZPVCU12	1	EZDPTPSG12	2	16.53	8	3/4 X 24	2	7/8 X 5	65

All dimensions are in inches unless noted otherwise. All weights are approximate in pounds unless noted otherwise.

Supporting documentation for the above 'General Specifications' and 'Optional Specifications' are available upon request to review, in addition to Installation Instructions and any requested material samples

Please contact SIP for technical assistance of nonstandard applications, pressures and bell dimensions that exceed listed X dimensions

Please refer to our web page www.sipindustries.com for up to date product data and technical advisorie