



## 3" - 36" MECHANICAL JOINT RETAINER GLANDS

### Submittal Information

Project Name / Location:	
Engineer:	
Referenced Specs:	
Distributor / Contractor:	

### Optional Specifications

Coating:	Asphaltic Seal Coat <i>In Accordance With ANSI/AWWA C104/A21.4</i>
	Other - Specify:
Bolts / Nuts:	Standard High Strength Low Alloy Steel (HSLA) <i>In Accordance With ANSI/AWWA C111/A21.11</i>
	Stainless Steel:           Type 304                   Type 316
	Other - Specify:
Gaskets:	Standard SBR (Buna-S) <i>In Accordance With ANSI/AWWA C111/A21.11</i>
	Other - Specify:

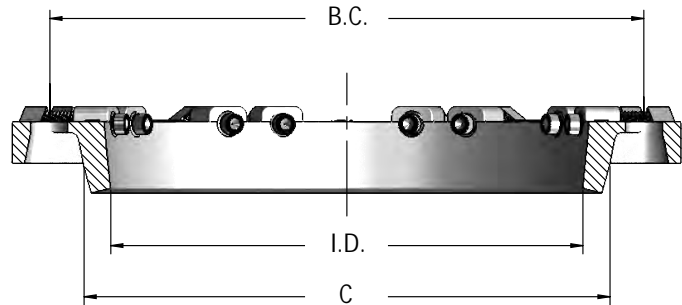
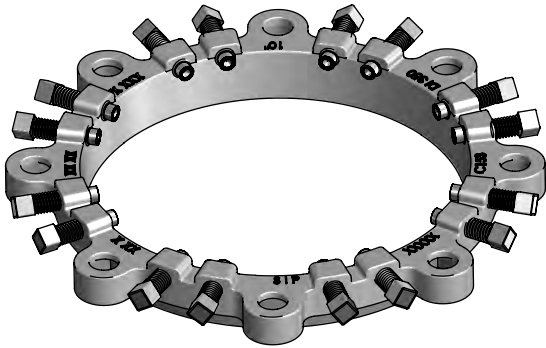

### General Specifications

- Material** : Ductile Iron per ASTM A536, Grade 65-45-12
- Pressure** : 350 PSI rating for sizes 3" - 6", 250 PSI rating for sizes 8" - 16", 200 PSI rating for sizes 18" - 24", 100 PSI rating for sizes 30" - 36"
- Testing** : In accordance with ANSI/AWWA C111/A21.11
- Dimensions** : In accordance with ANSI/AWWA C111/A21.11, C110/A21.10, and C153/A21.53 Standards  
All dimensions are inches unless otherwise noted
- Weights** : Are in pounds, unless otherwise noted and do not include accessories
- Set Screws** : ANSI 4140 steel, Heat Treated and Zinc Plated.
- Approvals** : NSF - 61 & 372 for coating(s) | FM Approved for sizes 3"-24" | UL/NSF 61 Approved



### Technical Specifications

Select Size	Size	Series Number	Ductile Iron Pipe O.D.	WWP Rating PSI	I.D.	C	B.C.	Bolt Hole		Set Screws			Approx. Weight (LBS)
								Qty.	Dia.	Qty.	Size	Torque (ft. lbs)	
	3	6681	3.96	350	4.06	4.84	6.19	4	3/8	4	3/8 x 2	85	5
	4	6682	4.80	350	4.90	5.92	7.50	4	7/8	4	3/8 x 2	85	7
	6	6683	6.90	350	7.00	8.02	9.50	6	7/8	6	3/8 x 2	85	12
	8	6684	9.05	250	9.15	10.17	11.75	6	7/8	9	3/8 x 2	85	16
	10	6685	11.10	250	11.20	12.22	14.00	8	7/8	16	3/8 x 2	85	22
	12	6686	13.20	250	13.30	14.32	16.25	8	7/8	16	3/8 x 2	85	28
	14	6687	15.30	250	15.44	16.40	18.75	10	7/8	20	3/8 x 2	85	45
	16	6688	17.40	250	17.54	18.50	21.00	12	7/8	24	3/8 x 2	85	52
	18	6689	19.50	200	19.64	20.60	23.25	12	7/8	24	3/8 x 2	85	62
	20	6690	21.60	200	21.74	22.70	25.50	14	7/8	28	3/8 x 2	85	75
	24	6691	25.80	200	25.94	26.90	30.00	16	7/8	32	3/8 x 2	85	97
	30	6691.30	32.00	100	32.17	33.29	36.88	20	1 1/8	40	3/4 x 2 1/2	110	196
	36	6691.36	28.30	100	38.47	39.59	43.75	24	1 1/8	48	3/4 x 2 1/2	110	246

\* This Restraint Product is not for use on Plastic Pipe.

Please refer to our web page [www.sipindustries.com](http://www.sipindustries.com) for up to date product data and technical advisories